

**SECTION 4 CONTENTS**

<b>ASSORTMENT / MOUNT KITS</b> .....	94	Retaining, Nylon .....	90
<b>EXTREME TEMPERATURE NYLON</b> .....	86	Surface Mount .....	86
<b>INSERTS, THREADED SMT</b> .....	86	Swage .....	87
<b>PC SPACERS, NYLON</b>		<b>THREADED STANDOFFS</b>	
Adhesive, Lock-In .....	93	Ceramic .....	88
Lock-in .....	92-93	Female - Female .....	85
Lock-in - Release .....	92-93	Force Fit .....	87
Reverse Chassis Mount .....	93	Hinged .....	90
Support .....	93	Male - Female .....	84
Threaded .....	92	Metric .....	89
<b>PC 104 MOUNTING KITS</b> .....	84	Swage .....	87
<b>SPACERS</b>		Surface Mount .....	86
Clear Hole .....	88	Nylon .....	84
Economy .....	88		
Force Fit .....	87		

**FOR CUSTOM DESIGNS:**  
 Visit our online Part Builder  
 at [keylco.com](http://keylco.com)

# MALE/FEMALE THREADED STANDOFFS

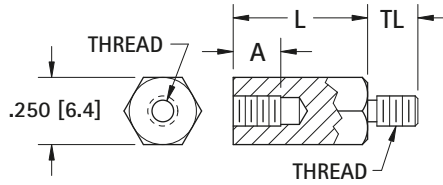

THREAD SIZE	TL EXTERNAL	A INTERNAL
4-40	.187 (4.7)	.250 (6.4)
6-32	.250 (6.4)	.375 (9.5)
8-32	.375 (9.5)	.375 (9.5)

**Application Note:**  
For PC 104 applications use length .600 (15.2) 4-40 Thread

CHOICE OF:		
<b>Stainless:</b> ASTM A581/A582	<b>Brass:</b> ASTM-B16 <b>Plating:</b> Nickel (QQ-N-290)	<b>Aluminum:</b> ASTM B211 <b>Plating:</b> Clear Iridite (Mil-C-5541)

4-40 THREAD			
L LENGTH	STAINLESS STEEL CAT NO.	BRASS CAT NO.	ALUMINUM CAT NO.
.250 (6.4)***	8712	8713	8714
.375 (9.5)	2087	7200	8400
.500 (12.7)	2088	1944	8401
.600 (15.2)*	5799	8799	6799
.625 (15.9)	2089	1945	8402
.750 (19.1)	2090	1946	8403
.875 (22.2)	2091	7201	8404
1.000 (25.4)	2092	1947	8405
1.125 (28.6)	2093	7202	8406
1.250 (31.8)	2094	1948	8407
1.375 (34.9)	2095	1949	8408
1.500 (38.1)	2096	1950	8409
1.625 (41.3)	2097	7203	8410
1.750 (44.5)	2098	7205	8411
2.000 (50.8)	2099	1951	8412

6-32 THREAD			
L LENGTH	STAINLESS STEEL CAT NO.	BRASS CAT NO.	ALUMINUM CAT NO.
.250 (6.4)***	8715	8716	8717
.375 (9.5)**	2119	7210	8413
.500 (12.7)	2120	1952	8414
.625 (15.9)	2121	1953	8415
.750 (19.1)	2122	1954	8416
.875 (22.2)	2123	7211	8417
1.000 (25.4)	2124	1644	8418
1.125 (28.6)	2125	7212	8419
1.250 (31.8)	2126	1955	8420
1.375 (34.9)	2127	1956	8421
1.500 (38.1)	2128	1645	8422
1.625 (41.3)	2129	7214	8423
1.750 (44.5)	2130	7215	8424
2.000 (50.8)	2131	1646	8425

8-32 THREAD			
L LENGTH	STAINLESS STEEL CAT NO.	BRASS CAT NO.	ALUMINUM CAT NO.
.250 (6.4)***	8731	8732	8733
.375 (9.5)**	2149	7220	8426
.500 (12.7)	2150	1957	8427
.625 (15.9)	2151	1958	8428
.750 (19.1)	2152	1959	8429
.875 (22.2)	2153	7221	8430
1.000 (25.4)	2154	1960	8431
1.125 (28.6)	2155	7222	8432
1.250 (31.8)	2156	1961	8433
1.375 (34.9)	2157	1962	8434
1.500 (38.1)	2158	1963	8435
1.625 (41.3)	2159	7224	8436
1.750 (44.5)	2160	7225	8437
2.000 (50.8)	2161	1964	8438
2.500 (63.5)	2180	1965	8439
3.000 (76.2)	2181	1966	8440

\*PC 104 Standard Length  
\*\*\*Internal Thread .130 (3.3)/.150 (3.8) Deep

\*\* Internal Thread .250 (6.4) Deep  
\*\*\* Internal Thread .130 (3.3)/.150 (3.8) Deep

\*\* Internal Thread .250 (6.4) Deep  
\*\*\* Internal Thread .130 (3.3)/.150 (3.8) Deep

## PC 104 MOUNTING KITS

- Designed to ease the assembly of new modules and multi-board stacks
- Each kit includes all the hardware that is required to mount a single-board

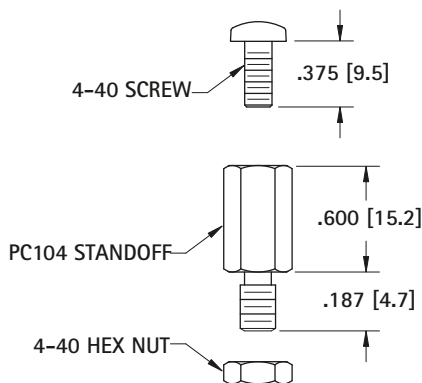

Complete Kit CAT. NO.	Kit Description	Includes Four (4) each:		
		Standoff	Screw	Nut
4799-4	Nylon	4799	9328	9605
5799-4	Stainless Steel	5799	9901	7248-3
6799-4	Aluminum	6799	9301*	9600*
8799-4	Brass	8799	9301*	9600*

\* Aluminum and brass kits supplied with steel hardware.

## NYLON STANDOFFS

**MATERIAL:** Nylon 6/6

MALE/FEMALE STANDOFFS

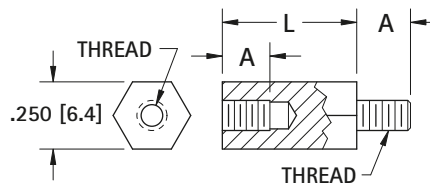

L LENGTH	THREAD SIZE		
	4-40 CAT. NO.	6-32 CAT. NO.	8-32 CAT. NO.
.250 (6.4)***	4800	4814	4828
.375 (9.5)	4801	4815	4829**
.500 (12.7)	4802	4816	4830
.600 (15.2)*	4799	-	-
.625 (15.9)	4803	4817	4831
.750 (19.1)	4804	4818	4832
.875 (22.2)	4805	4819	4833
1.000 (25.4)	4806	4820	4834
1.125 (28.6)	4807	4821	4835
1.250 (31.8)	4808	4822	4836
1.375 (34.9)	4809	4823	4837
1.500 (38.1)	4810	4824	4838
1.625 (41.3)	4811	4825	4839
1.750 (44.5)	4812	4826	4840
2.000 (50.8)	4813	4827	4841

\* PC 104 Standard Length  
\*\* Internal Thread .250 (6.4) Deep  
\*\*\* Internal Thread .130 (3.3)/.150 (3.8) Deep

**Application Note:**  
For PC 104 applications use CAT. NO. 4799

THREAD SIZE	A
4-40	.187 (4.7)
6-32	.250 (6.4)
8-32	.375 (9.5)

HEX MALE/FEMALE STANDOFFS

# FEMALE THREADED STANDOFFS

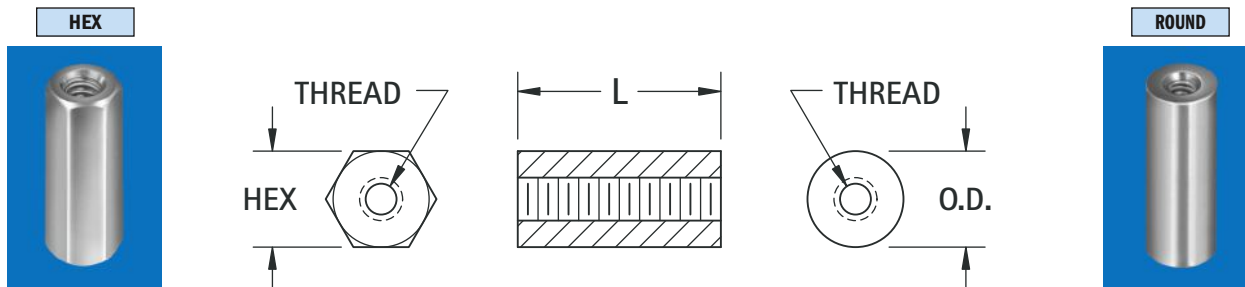

CHOICE OF:			
Nylon V2: Standard Nylon Nylon V0: Flame Resistant	Stainless: ASTM A581/A582	Brass: per ASTM-B16 Plating: Zinc ASTM B633	Aluminum: ASTM B211 Plating: Clear Iridite Finish

HEX	HEX					LENGTH	ROUND		O.D.
	NYLON V2 CAT. NO.	NYLON V0 CAT. NO.	STAINLESS CAT. NO.	BRASS CAT. NO.	ALUMINUM CAT. NO.		BRASS CAT. NO.	ALUMINUM CAT. NO.	
<b>2-56 THREAD</b>									
.156 (3.9)	—	—	—	1798A	1797A	.187 (4.7)	1802A	1801A	.156 (3.9)
	—	—	—	1798B	1797B	.250 (6.4)	1802B	1801B	
	—	—	—	1798C	1797C	.312 (7.9)	1802C	1801C	
	—	—	—	1798D	1797D	.375 (9.5)	1802D	1801D	
<b>4-40 THREAD</b>									
.187 (4.7)	—	—	—	1450	1891	.250 (6.4)	1547	2025	.187 (4.7)
	—	—	—	1803	1892	.375 (9.5)	1864	2026	
	—	—	—	1656	1893	.500 (12.7)	1657	2027	
	—	—	—	1804	1894	.625 (15.9)	1865	2028	
	—	—	—	1656A	1895	.750 (19.1)	1657A	2029	
	—	—	—	1805	1896	.875 (22.2)	1866	2030	
.250 (6.3)	—	—	—	1656B	1897	1.000 (25.4)	1657B	2031	.250 (6.3)
	1902A	8440A	1921	1450A	2201	.250 (6.4)	1547A	3478	
	1902B	8440B	1921A	1450B	2202	.375 (9.5)	1547B	3479	
	1902C	8440C	1921B	1450C	2203	.500 (12.7)	1547C	3480	
	1902D	8440D	—	1829	1808	.625 (15.9)	1867	1839	
	1902E	8440E	1921C	1450D	2204	.750 (19.1)	1547D	3481	
	1902G	8440F	—	1830	1809	.875 (22.2)	1876	1846	
	1902F	8440G	1921D	1450E	2205	1.000 (25.4)	1547E	3482	
—	—	1921E	1831	2206	1.500 (38.1)	1877	3483		
—	—	1921F	1832	2207	2.000 (50.8)	1878	3484		
<b>6-32 THREAD</b>									
.250 (6.3)	1903A	8441A	1922	1451A	2208	.250 (6.4)	1548A	3485	.250 (6.3)
	1903B	8441B	1922A	1451B	2209	.375 (9.5)	1548B	3486	
	1903C	8441C	1922B	1451C	2210	.500 (12.7)	1548C	3487	
	1903F	8441D	—	1451D	1813	.625 (15.9)	1548D	1847	
	1903D	8441E	1922C	1451E	2211	.750 (19.1)	1548E	3488	
	1903G	8441F	—	1833	1816	.875 (22.2)	1879	1848	
	1903E	8441G	1922D	1635	2212	1.000 (25.4)	1548F	3489	
	—	—	—	1636	1818	1.250 (31.8)	1881	1853	
	—	—	1922E	1637	2213	1.500 (38.1)	1882	3490	
	—	—	—	1638	1819	1.750 (44.5)	1883	1855	
	—	—	1922F	1639	2214	2.000 (50.8)	1884	3491	
	—	—	—	1642	1820	2.250 (57.2)	1885	1856	
	—	—	—	1643	1825	2.500 (63.5)	1886	1857	
	<b>8-32 THREAD</b>								
.250 (6.3)	1904A	8442A	1923	1474A	2215	.250 (6.4)	1692A	3492	.250 (6.3)
	1904B	8442B	1923A	1474B	2216	.375 (9.5)	1692B	3493	
	1904C	8442C	1923B	1474C	2217	.500 (12.7)	1692C	3494	
	1904F	8442D	—	1834	1827	.625 (15.9)	1887	1858	
	1904D	8442E	1923C	1474D	2218	.750 (19.1)	1692D	3495	
	1904G	8442F	—	1836	1828	.875 (22.2)	1888	1859	
	1904E	8442G	1923D	1474E	2219	1.000 (25.4)	1692E	3496	
	—	—	1923E	1837	2220	1.500 (38.1)	1889	3497	
	—	—	1923F	1838	2221	2.000 (50.8)	1899	3498	
<b>10-32 THREAD</b>									
.312 (7.9)	—	—	1475A	1822A	1821A	.375 (9.5)	3499A	3500A	.312 (7.9)
	—	—	1475B	1822B	1821B	.500 (12.7)	3499B	3500B	
	—	—	1475C	1822C	1821C	.625 (15.9)	3499C	3500C	
	—	—	1475D	1822D	1821D	.750 (19.1)	3499D	3500D	
	—	—	1475F	1822F	1821F	1.000 (25.4)	3499F	3500F	

NOTE: All standoffs over 1.000 (25.4) are tapped .375 (9.5) min. both ends, except 4-40 standoffs which are tapped .250 (6.4) min.

# SURFACE MOUNT STANDOFFS & SPACERS

SUPPLIED ON TAPE AND REEL



SMT Standoffs & Spacers are supplied on tape and reel with Kapton tape added to the top surface. This allows for the standoff to be placed on the circuit board using standard vacuum pick and place equipment. Attachment of the standoff to the PCB is completely controlled. Costly scrapping of populated board due to improper installation of swage or broaching spacer is eliminated.

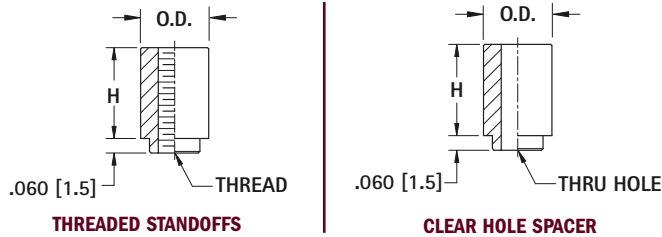

**MATERIAL:** Steel, Tin Plate  
**PACKAGING:** Supplied on 13 inch reels with Kapton tape added to top surface of standoff for vacuum pickup

Metric Standoffs				
CAT. NO.	H HEIGHT	PARTS/ REEL	THREAD	OUTSIDE DIA. (O.D.)
24881	2.00 (.080)	1500	M3	5.56 (.219)
24882	3.00 (.118)	1000		
24883	4.00 (.157)	900		
24884	6.00 (.236)	650		
24885	8.00 (.315)	375		
24886	10.00 (.394)	300		

THREADED STANDOFFS	CLEAR HOLE SPACERS	SMT STANDOFFS & SPACERS			
CAT. NO.	CAT. NO.	H HEIGHT	PARTS/ REEL*	THREAD	OUTSIDE DIA. (O.D.)
4871	—	.062 (1.57)	1500	2-56	.219 (5.6)
4873	—	.250 (6.35)	650		
4881	4886	.062 (1.57)	1500	4-40	.219 (5.6)
4882	4887	.125 (3.18)	1000		
4883	4888	.250 (6.35)	650		
4884	4889	.375 (9.52)	300		
4891	4896	.062 (1.57)	1500	6-32	.281 (7.1)
4892	4897	.125 (3.18)	1000		
4893	4898	.250 (6.35)	650		
4894	4899	.375 (9.53)	300		

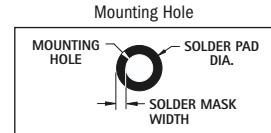

THREAD	MOUNTING HOLE	SOLDER PAD DIA.	SOLDER MASK WIDTH
2-56	.147 (3.7)	.244 (6.2)	.049 (1.2)
4-40	.166 (4.2)	.244 (6.2)	.039 (1.0)
6-32	.213 (5.41)	.306 (7.8)	.047 (1.2)
M3	.166 (4.2)	.244 (6.2)	.039 (1.0)

STANDOFFS

## SURFACE MOUNT THREADED INSERTS

SUPPLIED ON TAPE AND REEL

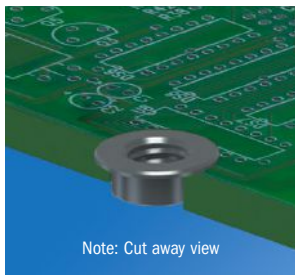

Note: Cut away view

Zero height threaded inserts sit just .012 (0.30) above the board for an easy method of adding threads to PCB. Can be installed using same equipment and processes as any SMT product.

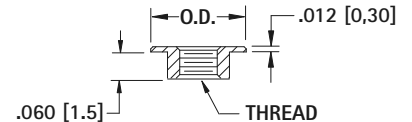
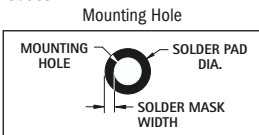

**MATERIAL:** Steel, Tin Plate  
**PACKAGING:** Supplied on 13 inch reels with Kapton tape added to top surface of standoff for vacuum pick-up

THREAD	MOUNTING HOLE	SOLDER PAD DIA.	SOLDER MASK WIDTH
2-56	.147 (3.7)	.244 (6.2)	.049 (1.2)
4-40	.166 (4.2)	.244 (6.2)	.039 (1.0)
6-32	.213 (5.41)	.306 (7.8)	.047 (1.2)

Zero Height SMT Threaded Inserts				
CAT. NO.	THREAD	OUTSIDE DIA. (O.D.)	H HEIGHT	PARTS/ REEL
4929	2-56	.219 (5.6)	.012 (.30)	1500
2439	4-40	.219 (5.6)		
4949	6-32	.281 (7.1)		

## EXTREME TEMPERATURE NYLON STANDOFFS



Keystone's high performance nylon standoffs will stand up to harsh conditions such as automotive under hood applications. The standoffs are manufactured with a material that was specifically designed to survive the most extreme conditions. The plastic is designed to stay pliable and maintain its tensile strength in extreme cold and heat.

**MATERIAL:** High Performance Nylon Blend. Black  
**Operating Temperature:** -20°F (-29°C) thru 365°F (185°C)

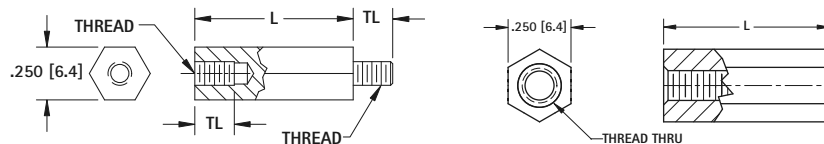

THREAD	TL
4-40	.187 (4.7)
6-32	.250 (6.4)
8-32	.375 (9.5)

HIGH PERFORMANCE MALE/FEMALE			
L LENGTH	4-40 CAT. NO.	6-32 CAT. NO.	8-32 CAT. NO.
.250 (6.4)†	4940	4970	4980
.375 (9.5)	4941	4971	4981
.500 (12.7)	4942	4972	4982
.750 (19.1)	4944	4974	4984
1.000 (25.4)	4946	4976	4986

HIGH PERFORMANCE FEMALE/FEMALE			
L LENGTH	4-40 CAT. NO.	6-32 CAT. NO.	8-32 CAT. NO.
.250 (6.4)	4842	4874	4932
.375 (9.5)	4843	4875	4933
.500 (12.7)	4844	4876	4934
.750 (19.1)	4846	4878	4936
1.000 (25.4)	4848	4880	4938

† .140 (3.56) Internal Thread Depth

## SWAGE THREADED STANDOFFS

ROUND

HEX

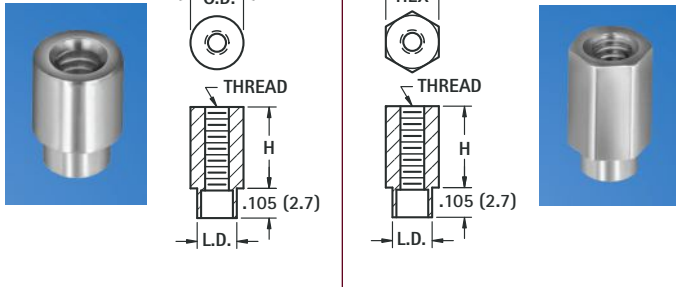

**MATERIAL:** Brass, ASTM-B16, Ductile Nickel Plate (QQ-N-290)  
For .062 (1.57) boards

ROUND CAT. NO.	H HEIGHT ABOVE PANEL	L.D. SHANK DIAMETER	HEX CAT. NO.
<b>2-56 THREAD × .156 (4.0) O.D.</b>			
1589-2	.125 (3.2)	.125 (3.2)	1731-2
1590-2	.187 (4.7)	.125 (3.2)	1734-2
1591-2	.250 (6.4)	.125 (3.2)	1740-2
1596-2	.375 (9.5)	.125 (3.2)	1743-2
<b>4-40 THREAD × .187 (4.7) O.D.</b>			
2260-2	.125 (3.2)	.139 (3.5)	2270-2
2261-2	.187 (4.7)	.139 (3.5)	2271-2
2262-2	.250 (6.4)	.139 (3.5)	2272-2
2263-2	.375 (9.5)	.139 (3.5)	2273-2
2264-2	.500 (12.7)	.139 (3.5)	2274-2
<b>4-40 THREAD × .250 (6.4) O.D.</b>			
1560A	.125 (3.2)	.187 (4.7)	1653-2
1790-2	.187 (4.7)	.187 (4.7)	1746-2
1650-2	.250 (6.4)	.187 (4.7)	1627-2
1651-2	.375 (9.5)	.187 (4.7)	1628-2
1623-2	.500 (12.7)	.187 (4.7)	1629-2
1624-2	.625 (15.9)	.187 (4.7)	1654-2
1625-2	.750 (19.1)	.187 (4.7)	1655-2
1792-2	.875 (22.2)	.187 (4.7)	1749-2
1652-2	1.000 (25.4)	.187 (4.7)	1630-2
<b>6-32 THREAD × .250 (6.4) O.D.</b>			
1560B	.125 (3.2)	.187 (4.7)	1620-2
1612-2	.187 (4.7)	.187 (4.7)	1752-2
1546	.250 (6.4)	.187 (4.7)	1621-2
1561B	.375 (9.5)	.187 (4.7)	1622-2
1604-2	.500 (12.7)	.187 (4.7)	1758-2
1605-2	.625 (15.9)	.187 (4.7)	1759-2
1608-2	.750 (19.1)	.187 (4.7)	1761-2
1796-2	.875 (22.2)	.187 (4.7)	1775-2
1609-2	1.000 (25.4)	.187 (4.7)	1784-2

## SWAGE CLEAR HOLE SPACERS

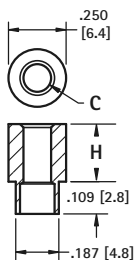

CAT. NO.	H HEIGHT ABOVE PANEL	C HOLE
5058-2	.125 (3.2)	.120 (3.0) For # 4
5060-2	.250 (6.4)	
5061-2	.375 (9.5)	
5062-2	.500 (12.7)	
5059-2	.125 (3.2)	.140 (3.5) For # 6
5063-2	.250 (6.4)	
5064-2	.375 (9.5)	
5065-2	.500 (12.7)	

**MATERIAL:** Brass, ASTM-B16, Ductile Nickel Plate (QQ-N-290)  
For .062 (1.57) boards

## FORCE-FIT STANDOFFS

ROUND

A broaching-type fastener/standoff for installation in panels and circuit boards .062 (1.57) and thicker made of plastic and other non-ductile materials. Available threaded or with clearance holes. Easy to install, presses into punched or drilled holes.

**MATERIAL:** Stainless Steel per ASTM-A581/A582

### MOUNTING HOLES:

- .147 (3.7) hole for 2-56
- .166 (4.2) hole for 4-40
- .213 (5.4) hole for 6-32

### TOLERANCE ON MOUNTING HOLES:

+0.003/-0.000

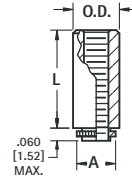

Threaded

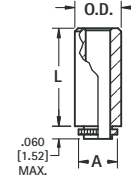

Clear Hole

THREADED				
CAT. NO.	L LENGTH	O.D.	A	THREAD
4860	.065 (1.7)	.219 (5.6)	.165 (4.2)	2-56
4861	.065 (1.7)	.219 (5.6)	.184 (4.7)	4-40
4862	.125 (3.2)	.219 (5.6)	.184 (4.7)	
4718	.187 (4.7)	.219 (5.6)	.184 (4.7)	
4863	.250 (6.4)	.219 (5.6)	.184 (4.7)	
4864	.375 (9.5)	.219 (5.6)	.184 (4.7)	
4865 *	.500 (12.7)	.219 (5.6)	.184 (4.7)	
4866	.065 (1.7)	.281 (7.1)	.231 (5.9)	
4867	.125 (3.2)	.281 (7.1)	.231 (5.9)	
4722	.187 (4.7)	.281 (7.1)	.231 (5.9)	
4868	.250 (6.4)	.281 (7.1)	.231 (5.9)	
4869	.375 (9.5)	.281 (7.1)	.231 (5.9)	
4870 *	.500 (12.7)	.281 (7.1)	.231 (5.9)	

\*Thread depth .375 (9.5)

CLEAR HOLE				
CAT. NO.	L LENGTH	O.D.	A	HOLE
4850	.065 (1.7)	.219 (5.6)	.184 (4.7)	.116 (2.9) For # 4
4851	.125 (3.2)	.219 (5.6)	.184 (4.7)	
4852	.250 (6.4)	.219 (5.6)	.184 (4.7)	
4853	.375 (9.5)	.219 (5.6)	.184 (4.7)	
4854	.500 (12.7)	.219 (5.6)	.184 (4.7)	.143 (3.6) For # 6
4855	.065 (1.7)	.281 (7.1)	.231 (5.9)	
4856	.125 (3.2)	.281 (7.1)	.231 (5.9)	
4857	.250 (6.4)	.281 (7.1)	.231 (5.9)	
4858	.375 (9.5)	.281 (7.1)	.231 (5.9)	
4859	.500 (12.7)	.281 (7.1)	.231 (5.9)	

## SWAGE STAKING TOOLS

Precision made staking tool kits are made from .250 (6.4) diameter heat treated steel, zinc plated. Each kit includes the correct swage top staking tool anvil to create a professional appearance. These tools may be used with an arbor press or hand tapped.

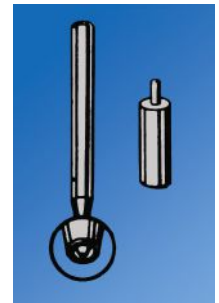

CAT. NO.	STANDOFF DIA.	THREAD	HOLE SIZE
TL-19	.156 (4.0)	2-56	-
TL-22	.187 (4.7)	4-40	-
TL-20	.250 (6.4)	4-40	-
TL-21	.250 (6.4)	6-32	.120 (3.0)

## ROUND CLEAR HOLE SPACERS

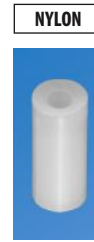
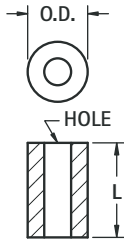

**MATERIAL:** Brass: ASTM-B16, Nickel Plate (QQ-N-290) Aluminum: ASTM B211, Clear Iridite (MIL-C-5541) Nylon: Nylon 6/6, UL Rated 94V-2

CLEAR HOLE	O.D.	L LENGTH	BRASS CAT. NO.	ALUMINUM CAT. NO.	NYLON CAT. NO.	CLEAR HOLE	O.D.	L LENGTH	BRASS CAT. NO.	ALUMINUM CAT. NO.	NYLON CAT. NO.
.120 (3.0) For #4	.250 (6.4)	.125 (3.2)	1909	2036	875	.170 (4.3) For #8	.250 (6.4)	.125 (3.2)	1942	4258	891
		.250 (6.4)	1454A	3457	776			.250 (6.4)	1480	3471	892
		.375 (9.5)	1454B	3458	877			.375 (9.5)	1481	3472	893
		.500 (12.7)	1454C	3459	878			.500 (12.7)	1482	3473	894
		.625 (15.9)	1919	2314	879			.625 (15.9)	3032	4259	895
		.750 (19.1)	1454D	3460	880			.750 (19.1)	1483	3474	896
		.875 (22.2)	1920	3402	881			.875 (22.2)	2033	4260	897
		1.000 (25.4)	1454E	3461	882			1.000 (25.4)	1484	3475	898
		1.500 (38.1)	1924	3462	779			1.500 (38.1)	2034	3476	799
2.000 (50.8)	1925	3463	—	2.000 (50.8)	2035	3477	—				
.140 (3.5) For #6	.250 (6.4)	.125 (3.2)	1934	3403	883	.196 (5.0) For #10	.312 (7.9)	—	—	—	—
		.250 (6.4)	1457A	3464	884			.250 (6.4)	1662	4261	790
		.375 (9.5)	1457B	3465	885			.375 (9.5)	1663	4262	791
		.500 (12.7)	1457C	3466	886			.500 (12.7)	1664	4263	792
		.625 (15.9)	1935	3429	887			.625 (15.9)	1665	4264	793
		.750 (19.1)	1457D	3467	888			.750 (19.1)	1666	4265	794
		.875 (22.2)	1936	3438	889			.875 (22.2)	1667	4266	795
		1.000 (25.4)	1457E	3468	890			1.000 (25.4)	1668	4267	796
		1.500 (38.1)	1937	3469	789			1.500 (38.1)	1669	4268	797
		2.000 (50.8)	1938	3470	—			2.000 (50.8)	1672	4269	—

\*Visit our Parts Builder System online ([www.keyelco.com](http://www.keyelco.com)) to see all of our spacer offerings.

## ALUMINUM ECONOMY SPACERS



- Made of flat strip aluminum and rolled on precision equipment
- Assures maximum bearing surface, square ends
- Tight Joint on Outside Diameter

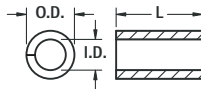

**MATERIAL:** Aluminum

SPACER FOR	I.D.	O.D. REF.
# 4	.120 (3.0)	.167 (4.2)
# 6	.148 (3.8)	.193 (4.9)
# 8	.176 (4.5)	.232 (5.9)

L LENGTH	SCREW CLEARANCE		
	# 4 CAT. NO.	# 6 CAT. NO.	# 8 CAT. NO.
.187 (4.7)	397	—	—
.250 (6.4)	398	405	412
.312 (7.9)	399	406	413
.375 (9.5)	400	407	414
.437 (11.1)	401	408	415
.500 (12.7)	402	409	416
.625 (15.9)	403	410	417

L LENGTH	SCREW CLEARANCE		
	# 4 CAT. NO.	# 6 CAT. NO.	# 8 CAT. NO.
.750 (19.1)	418	425	432
.875 (22.2)	419	426	—
1.000 (25.4)	420	427	434
1.250 (31.8)	421	428	435
1.500 (38.1)	422	429	436
1.750 (44.5)	—	430	437
2.000 (50.8)	—	—	438

## CERAMIC STANDOFFS

- Ideal for very high temperature conditions
- Commercial and military types available
- Military types meet MIL-1-010, NL # clearly marked
- Exceptional strength in compression and tension
- Withstands very high voltage without flashover
- Special sizes available upon request

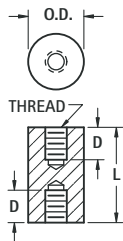

### COMMERCIAL

CAT. NO.	L LENGTH	O.D.	T THREAD	D DEPTH
7710	.250 (6.4)	.250 (6.4)	6-32	THRU
7711	.500 (12.7)	.250 (6.4)	6-32	.156 (4.0)
7712	.375 (9.5)	.375 (9.5)	6-32	.156 (4.0)
7713	.500 (12.7)	.375 (9.5)	6-32	.156 (4.0)
7714	.500 (12.7)	.500 (12.7)	6-32	.140 (3.6)
7715	.750 (19.1)	.500 (12.7)	6-32	.250 (6.4)
7716	1.000 (25.4)	.500 (12.7)	6-32	.375 (9.5)
7717	1.500 (38.1)	.500 (12.7)	6-32	.562 (14.3)
7718	2.500 (63.5)	.500 (12.7)	6-32	.500 (12.7)
7719	2.500 (63.5)	.750 (19.1)	1/4 - 20	.750 (19.1)
7720	4.000 (101.6)	.750 (19.1)	1/4 - 20	.750 (19.1)

### MILITARY

CAT. NO.	L LENGTH	O.D.	T THREAD	D DEPTH	NL #
7661	.500 (12.7)	.375 (9.5)	6-32	.156 (4.0)	NL523W01-004
7662	.625 (15.9)	.375 (9.5)	6-32	.250 (6.4)	NL523W01-005
7663	.625 (15.9)	.500 (12.7)	8-32	.187 (4.7)	NL523W02-005
7664	.750 (19.1)	.375 (9.5)	6-32	.250 (6.4)	NL523W01-006
7665	.750 (19.1)	.500 (12.7)	8-32	.250 (6.4)	NL523W02-006
7666	1.000 (25.4)	.375 (9.5)	6-32	.375 (9.5)	NL523W01-008
7667	1.000 (25.4)	.500 (12.7)	8-32	.375 (9.5)	NL523W02-008
7668	1.000 (25.4)	.750 (19.1)	10-32	.375 (9.5)	NL523W03-008
7669	1.250 (31.8)	.375 (9.5)	6-32	.375 (9.5)	NL523W01-010
7670	1.250 (31.8)	.500 (12.7)	8-32	.375 (9.5)	NL523W02-010
7671	1.250 (31.8)	1.000 (25.4)	1/4 - 20	.437 (11.1)	NL523W04-010
7672	1.500 (38.1)	.375 (9.5)	6-32	.375 (9.5)	NL523W01-012
7673	1.500 (38.1)	.500 (12.7)	8-32	.375 (9.5)	NL523W02-012
7674	1.500 (38.1)	.750 (19.1)	10-32	.375 (9.5)	NL523W03-012
7675	1.500 (38.1)	1.000 (25.4)	1/4 - 20	.500 (12.7)	NL523W04-012
7676	2.000 (50.8)	.375 (9.5)	6-32	.375 (9.5)	NL523W01-016
7677	2.000 (50.8)	.500 (12.7)	8-32	.375 (9.5)	NL523W02-016
7678	2.000 (50.8)	.750 (19.1)	10-32	.375 (9.5)	NL523W03-016

**MATERIAL:** Grade L5 Ceramic

# METRIC STANDOFFS

MALE/FEMALE



THREAD SIZE	TL	A
M2.5	4.0	5.0
M3	8.0	8.0
M4	10.0	11.0

FEMALE

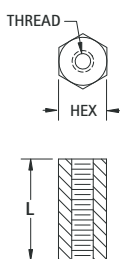
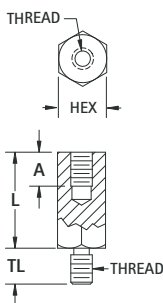

**CHOICE OF:**

<b>Stainless:</b> ASTM A581/A582	<b>Brass:</b> ASTM-B16 Plating: Nickel (QQ-N-290)	<b>Aluminum:</b> ASTM B211 Plating: Clear Iridite (Mil-C-5541)
----------------------------------	---	--

MALE/FEMALE				FEMALE		
STAINLESS CAT. NO.	BRASS CAT. NO.	ALUMINUM CAT. NO.	L	STAINLESS CAT. NO.	BRASS CAT. NO.	ALUMINUM CAT. NO.
<b>4.5 HEX DIA. (M2.5 THREAD)</b>						
—	—	—	5.0	24460	24380	24420
—	—	—	6.0	24461	24381	24421
—	—	—	8.0	24462	24382	24422
24283	24307	24331	10.0	24463	24383	24423
24284	24308	24332	12.0	24464	24384	24424
24285	24309	24333	15.0	24465	24385	24425
24286	24310	24334	18.0	24466	24386	24426
24287	24311	24335	20.0	24467	24387	24427
24288	24312	24336	25.0	24468	24388	24428
<b>5.0 HEX DIA. (M3 THREAD)</b>						
—	—	—	5.0	24470	24390	24430
—	—	—	6.0	24471	24391	24431
—	—	—	8.0	24472	24392	24432
24289	24313	24337	10.0	24473	24393	24433
24290	24314	24338	12.0	24474	24394	24434
24291	24315	24339	15.0	24475	24395	24435
24292	24316	24340	18.0	24476	24396	24436
24293	24317	24341	20.0	24477	24397	24437
24294	24318	24342	25.0	24478	24398	24438
<b>5.5 HEX DIA. (M3 THREAD)</b>						
—	—	—	5.0	24480	24400	24440
—	—	—	6.0	24481	24401	24441
—	—	—	8.0	24482	24402	24442
24295	24319	24343	10.0	24483	24403	24443
24296	24320	24344	12.0	24484	24404	24444
24297	24321	24345	15.0	24485	24405	24445
24298	24322	24346	18.0	24486	24406	24446
24299	24323	24347	20.0	24487	24407	24447
24300	24324	24348	25.0	24488	24408	24448
<b>6.0 HEX DIA. (M4 THREAD)</b>						
—	—	—	5.0	24490	24410	24450
—	—	—	6.0	24491	24411	24451
—	—	—	8.0	24492	24412	24452
24301**	24325**	24349**	10.0	24493	24413	24453
24302*	24326*	24350*	12.0	24494	24414	24454
24303	24327	24351	15.0	24495	24415	24455
24304	24328	24352	18.0	24496	24416	24456
24305	24329	24353	20.0	24497	24417	24457
24306	24330	24354	25.0	24498	24418	24458

\* Internal Thread: 8.0mm deep \*\* Internal Thread: 6.0mm deep  
Note: Female standoffs longer than 19mm may be tapped from both ends

# METRIC NYLON STANDOFFS

Material: Nylon 6/6, UL Rated 94V-2

MALE/FEMALE



THREAD SIZE	A
M3	8.0
M4	9.5

FEMALE

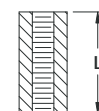
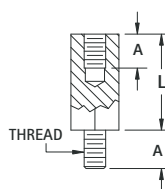
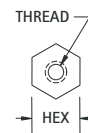
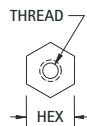

MALE/FEMALE CAT. NO.	L	FEMALE CAT. NO.
<b>5.0 HEX (M3 THREAD)</b>		
—	6.0	25508
—	8.0	25509
25501	10.0	25510
25502	12.0	25511
25503	15.0	25512
25504	18.0	25513
25505	20.0	25514
25506	25.0	25515
<b>6.0 HEX (M4 THREAD)</b>		
—	6.0	25528
—	8.0	25529
25521	10.0	25530
25522	12.0	25531
25523	15.0	25532
25524	18.0	25533
25525	20.0	25534
25526	25.0	25535

Note: Female standoffs longer than 19mm may be tapped from both ends

# METRIC NYLON LOCK-IN SUPPORT

- One end locks into chassis, the other end locks into the PC Board.

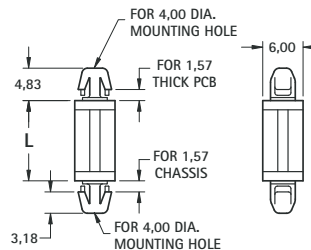

CAT. NO.	L DIM
8843	3.0
8844	4.0
8845	6.0
8846	8.0
8847	10.0
8848	12.0
8849	14.0
8850	16.0
8851	18.0

Material: Nylon 6/6, UL Rated 94V-0

# METRIC SCREWS

Choice of: Steel, Zinc Plate • Nylon: 6/6, UL Rated 94V-2

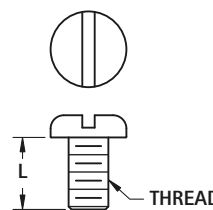

STEEL CAT. NO.	L	NYLON 6/6 CAT. NO.
<b>M2.5 THREAD</b>		
29300	4.00	29330
29301	6.00	29331
29304	12.00	29334
29306	16.00	29336
<b>M3 THREAD</b>		
29311	6.00	29341
29314	12.00	29344
29316	16.00	29346
29318	25.00	29348
<b>M4 THREAD</b>		
29321	6.00	29351
29324	12.00	29354
29326	16.00	29356
29328	25.00	29358

See page 131 for metric nuts

## NYLON RETAINING SPACERS

Similar to our standard spacers, but with a specially configured I.D. designed to grip the outside of the screw shank. The spacer slides on the screw easily, but is retained on the screw. For use in applications requiring pre-assembly of the screw and spacer, to reduce final assembly cost.

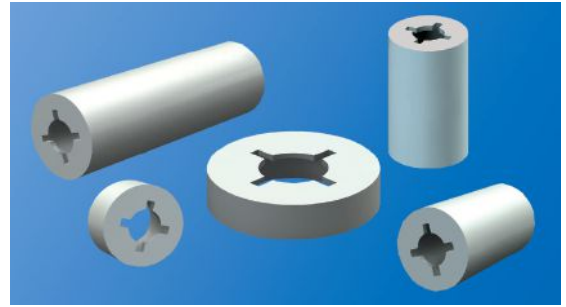
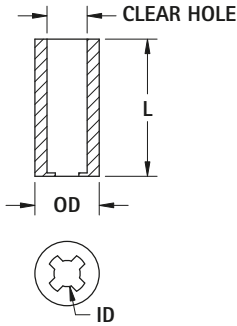

CAT. NO.	.156 (3.9) Clear Hole for #4 Screw		
	LENGTH	O.D.	I.D.
2341	.125 (3.2)	.250 (6.4)	.102 (2.6)
2342	.250 (6.4)		
2343	.375 (9.5)		
2344	.500 (12.7)		
2345	.625 (15.9)		
2346	.750 (19.1)		
2347	.875 (22.2)		
2348	1.00 (25.4)		

CAT. NO.	.198 (5.0) Clear Hole for #6 Screw		
	LENGTH	O.D.	I.D.
2361	.125 (3.2)	.312 (7.9)	.128 (3.3)
2362	.250 (6.4)		
2363	.375 (9.5)		
2364	.500 (12.7)		
2365	.625 (15.9)		
2366	.750 (19.1)		
2367	.875 (22.2)		
2368	1.00 (25.4)		

CAT. NO.	.240 (6.1) Clear Hole for #8 Screw		
	LENGTH	O.D.	I.D.
2381	.125 (3.2)	.375 (9.5)	.152 (3.8)
2382	.250 (6.4)		
2383	.375 (9.5)		
2384	.500 (12.7)		
2385	.625 (15.9)		
2386	.750 (19.1)		
2387	.875 (22.2)		
2388	1.00 (25.4)		

CAT. NO.	.277 (7.0) Clear Hole for #10 Screw		
	LENGTH	O.D.	I.D.
2391	.125 (3.2)	.500 (12.7)	.177 (4.5)
2392	.250 (6.4)		
2393	.375 (9.5)		
2394	.500 (12.7)		
2395	.625 (15.9)		
2396	.750 (19.1)		
2397	.875 (22.2)		
2398	1.00 (25.4)		

## HINGED STANDOFFS

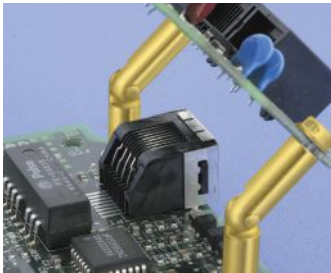

- Applications unlimited
- Time saving
- Space saving
- Interconnect circuits or services without danger of shorting

**MATERIAL:**  
Brass, ASTM-B16. Zinc Plate and Yellow Chromate



### EMALE/FEMALE



CAT. NO.	L LENGTH	U	P	D DIAMETER	T THREAD
351	.750 (19.1)	.172 (4.4)	.375 (9.5)	.187 (4.7)	4-40
352	1.000 (25.4)	.250 (6.4)	.625 (15.9)		
330	1.250 (31.8)	.250 (6.4)	.625 (15.9)	.250 (6.4)	6-32
353	.750 (19.1)	.172 (4.4)	.375 (9.5)		
354	1.000 (25.4)	.250 (6.4)	.625 (15.9)	.250 (6.4)	8-32
331	1.250 (31.8)	.250 (6.4)	.625 (15.9)		
355	.750 (19.1)	.172 (4.4)	.375 (9.5)	.250 (6.4)	8-32
356	1.000 (25.4)	.250 (6.4)	.625 (15.9)		
332	1.250 (31.8)	.250 (6.4)	.625 (15.9)		

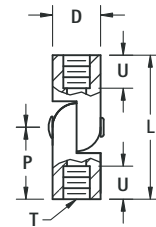

### MALE/FEMALE



CAT. NO.	L LENGTH	S	U	D DIAMETER	T THREAD
333	.625 (15.9)	.250 (6.4)	.172 (4.4)	.187 (4.7)	4-40
334	.875 (22.2)	.250 (6.4)	.250 (6.4)		
335	.625 (15.9)	.312 (7.9)	.172 (4.4)	.250 (6.4)	6-32
336	.875 (22.2)	.312 (7.9)	.250 (6.4)		
337	.625 (15.9)	.312 (7.9)	.172 (4.4)	.250 (6.4)	8-32
338	.875 (22.2)	.312 (7.9)	.250 (6.4)		

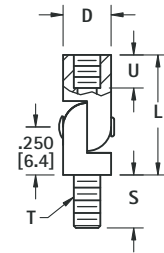

### MALE/MALE



CAT. NO.	L LENGTH	S	P	D DIAMETER	T THREAD
357	.500 (12.7)	.250 (6.4)	.250 (6.4)	.187 (4.7)	4-40
358	.500 (12.7)	.312 (7.9)	.250 (6.4)	.250 (6.4)	6-32
359	.500 (12.7)	.312 (7.9)	.250 (6.4)	.250 (6.4)	8-32

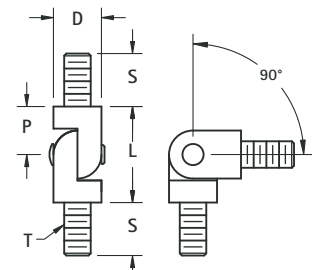



# INSULATED PC SPACER/SUPPORTS

- Board will be electrically insulated, eliminates need for insulating washers
- No tool required for installation
- Easy snap-in assembly
- One pieces design eliminates the need for additional screws and nuts
- Fits snug onto board
- Accommodates varying board thicknesses
- Flame retardant

INSULATED PC SPACERS/SUPPORTS

**.156 (4.0)** **SLIM-LINE TENSION-FIT**



- One end permanently attaches to .070 (1.78) max. thick chassis
- Other end tension fits to .062 (1.57) max. thick PC board
- Board is easily releasable for repairs or upgrades
- Low insertion force

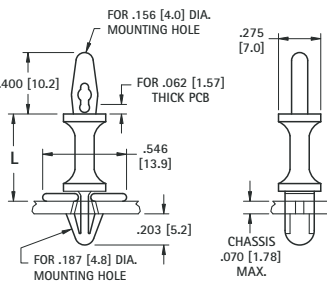

CAT. NO.	L LENGTH
1927A	.250 (6.4)
1928A	.375 (9.5)
1929A	.500 (12.7)
1930A	.625 (15.9)
1931A	.750 (19.1)
1932A	.875 (22.2)
1933A	1.000 (25.4)

**MATERIAL:** Nylon 6/6, UL Rated 94V-0

**.156 (4.0)** **SLIM-LINE LOCK-IN**



- One end permanently attaches to .070 (1.78) max. thick chassis
- Other end permanently attaches to .062 (1.57) max. thick PC board
- Low insertion force
- Small footprint frees up board space

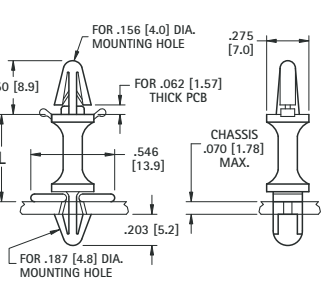

CAT. NO.	L LENGTH
1927B	.250 (6.4)
1928B	.375 (9.5)
1929B	.500 (12.7)
1930B	.625 (15.9)
1931B	.750 (19.1)
1932B	.875 (22.2)
1933B	1.000 (25.4)

**MATERIAL:** Nylon 6/6, UL Rated 94V-0

**.156 (4.0)** **STURDY TENSION-FIT**



- One end permanently attaches to .031(.79) - .078 (2.0) thick chassis
- Other end tension fits to .062 (1.57) max. thick PC board
- Board is easily releasable for repairs or upgrades
- Sturdy support due to high contact area

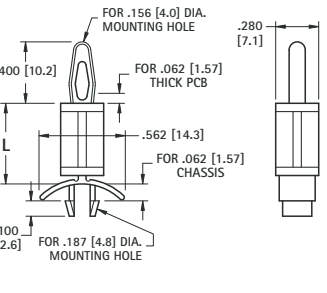

CAT. NO.	L LENGTH
8800	.187 (4.7)
8801	.250 (6.4)
8802	.375 (9.5)
8803	.500 (12.7)
8804	.625 (15.9)
8805	.750 (19.1)
8806	.875 (22.2)

**MATERIAL:** Nylon 6/6, UL Rated 94V-0

**.156 (4.0)** **STURDY LOCK-IN**



- Both ends permanently attaches to .031 (.79) - .078 (2.0) thick chassis or board
- Sturdy support due to high contact area

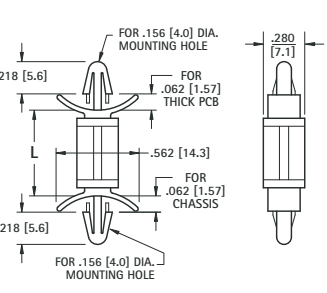

CAT. NO.	L LENGTH
8815	.187 (4.7)
8816	.250 (6.4)
8817	.375 (9.5)
8818	.500 (12.7)
8819	.625 (15.9)
8820	.750 (19.1)
8821	.875 (22.2)

**MATERIAL:** Nylon 6/6, UL Rated 94V-0

**.156 (4.0)** **STURDY LOCK-IN RELEASE**



- Locks onto .062 (1.57) thick PC board
- Board is positively locked until manually released
- Board is easily releasable for repairs or upgrades
- Sturdy support due to high contact area with chassis

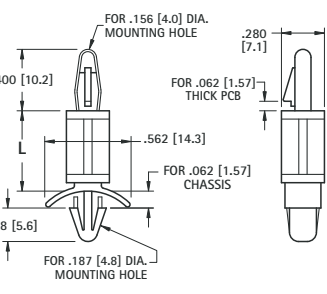

CAT. NO.	L LENGTH
8807	.187 (4.7)
8808	.250 (6.4)
8809	.375 (9.5)
8810	.500 (12.7)
8811	.625 (15.9)
8812	.750 (19.1)
8813	.875 (22.2)
8814	1.000 (25.4)

**MATERIAL:** Nylon 6/6, UL Rated 94V-0

**.125 (3.2)** **SLIM-LINE LOCK-IN RELEASE**



- Locks onto .062 (1.57) thick PC board
- Board is positively locked until manually unlocked
- Board is easily releasable for repairs or upgrades
- Compact design uses smaller mounting holes

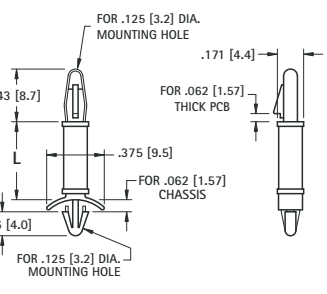

CAT. NO.	L LENGTH
8871	.187 (4.7)
8872	.250 (6.4)
8873	.375 (9.5)
8874	.500 (12.7)
8875	.625 (15.9)

**MATERIAL:** Nylon 6/6, UL Rated 94V-0

# INSULATED PC SPACERS/SUPPORTS

- Board will be electrically insulated, eliminates need for insulating washers
- Easy snap-in assembly
- No tool required for installation
- Designed for .062 (1.57) thick boards

- One piece design eliminates the need for additional screws and nuts
- Slim design frees up board space

.125 (3.2)

## TENSION-FIT



- One end permanently attaches to chassis
- Other end secures board with tension fit
- Board easily releasable for repairs or upgrades

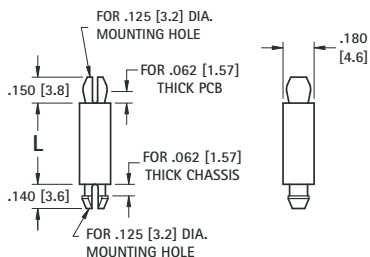

CAT. NO.	L LENGTH
8879	.125 (3.2)
8880	.187 (4.7)
8881	.250 (6.4)
8882	.375 (9.5)
8883	.500 (12.7)
8884	.625 (15.9)
8885	.750 (19.1)
8886	.875 (22.2)
8887	1.000 (25.4)

MATERIAL: Nylon 6/6, UL Rated 94V-0

.100 (2.6)

## EASY LOCK-IN



- Both ends permanently attach to chassis and board
- Teardrop style mounting end eases assembly
- Low protrusion above board and under chassis

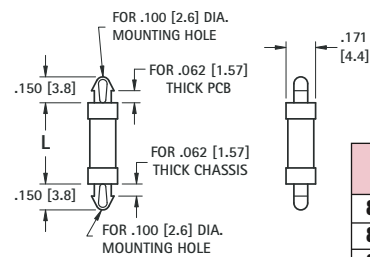

CAT. NO.	L LENGTH
8888	.125 (3.2)
8889	.187 (4.7)
8890	.250 (6.4)
8891	.375 (9.5)
8892	.500 (12.7)
8893	.625 (15.9)

MATERIAL: Nylon 6/6, UL Rated 94V-0

.125 (3.2)

## LOCK-IN



- Both ends permanently attach to chassis and board
- Secure mounting end design allows for taller spacing

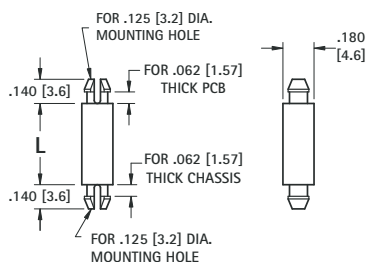

CAT. NO.	L LENGTH
9018	.125 (3.2)
9019	.187 (4.7)
9020	.250 (6.4)
9021	.375 (9.5)
9022	.500 (12.7)
9023	.625 (15.9)
9024	.750 (19.1)
9025	.875 (22.2)
9026	1.000 (25.4)

MATERIAL: Nylon 6/6, UL Rated 94V-0

.156 (4.0)

## THREADED

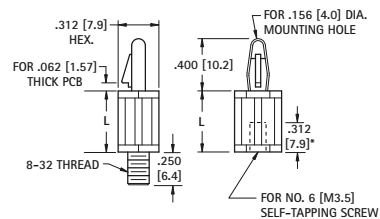

THREAD

- One end attaches to chassis with screw or tapped hole
- Other end snap locks onto .062 (1.6) board
- Board is releasable for easy repair or upgrades

MALE CAT. NO.	L LENGTH	FEMALE CAT. NO.
9048	.250 (6.4)	9041
9049	.375 (9.5)	9042
9050	.500 (12.7)	9043
9051	.625 (15.9)	9044
9052	.750 (19.1)	9045
9053	.875 (22.2)	9046
9054	1.000 (25.4)	9047

MATERIAL: Nylon 6/6, UL Rated 94V-0

## THRU HOLE SPACERS

One end locks into panel. Clear hole designs for #4, #6 or #8 screw.



- Base has larger surface area. Will not deform under heavy pre-load

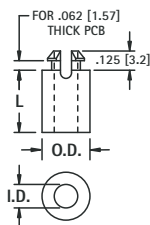

CAT. NO.	L LENGTH	Outside Diameter	Inside Diameter	Mounting Hole	Screw Size
9027	.125 (3.2)				
9028	.187 (4.7)				
9029	.250 (6.4)	.260 (6.6)	.125 (3.2)	.187 (4.7)	#4
9030	.375 (9.5)				
9031	.500 (12.7)				
9032	.625 (15.9)				
9033	.250 (6.4)				
9034	.375 (9.5)	.281 (7.1)	.153 (3.9)	.234 (5.9)	#6
9035	.500 (12.7)				
9036	.625 (15.9)				
9037	.250 (6.4)				
9038	.375 (9.5)	.281 (7.1)	.169 (4.3)	.234 (5.9)	#8
9039	.500 (12.7)				
9040	.625 (15.9)				

MATERIAL: Nylon 6/6, UL Rated 94V-0

## STACKING SPACERS

One end locks into panel. Clear hole designs for #4, #6 or #8 screw.



- Spacers can be stacked for multiple level PC board applications
- Self-aligning

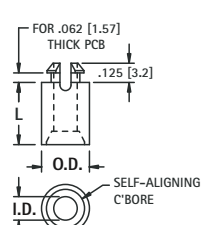

CAT. NO.	L LENGTH	Outside Diameter	Inside Diameter	Mounting Hole	Screw Size
8829	.125 (3.2)				
8830	.187 (4.7)				
8831	.250 (6.4)	.260 (6.6)	.125 (3.2)	.187 (4.7)	#4
8832	.375 (9.5)				
8833	.500 (12.7)				
8834	.625 (15.9)				
8835	.250 (6.4)				
8836	.375 (9.5)	.312 (7.9)	.153 (3.9)	.234 (5.9)	#6
8837	.500 (12.7)				
8838	.625 (15.9)				
8839	.250 (6.4)				
8840	.375 (9.5)	.312 (7.9)	.169 (4.3)	.234 (5.9)	#8
8841	.500 (12.7)				
8842	.625 (15.9)				

MATERIAL: Nylon 6/6, UL Rated 94V-0

# INSULATED PC SPACERS/SUPPORTS

- Board will be electrically insulated, eliminates need for insulating washers
- No tool required for installation • Easy snap-in assembly

## ADHESIVE LOCK-IN RELEASE SUPPORTS

- One end attaches to chassis with self adhesive pads
- No drilling to chassis required leaving outside in perfect condition
- Other end snap into .062 (1.57) board
- Board is easily releasable for repair or upgrade



.156 (4.0)

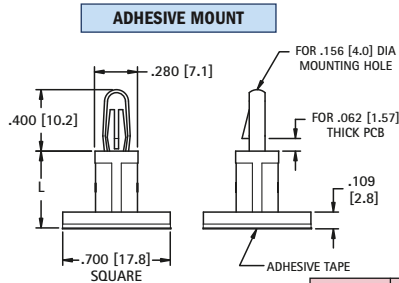

CAT. NO.	L LENGTH
9080	.187 (4.7)
9081	.250 (6.4)
9082	.375 (9.5)
9083	.500 (12.7)
9084	.625 (15.9)

Material: Nylon 6/6, UL Rated 94V-0



.125 (3.2)

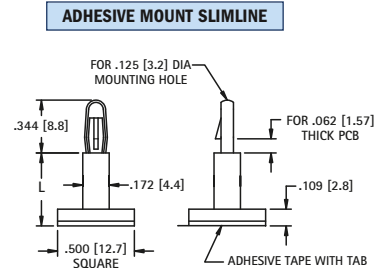

CAT. NO.	L LENGTH
9070	.187 (4.7)
9071	.250 (6.4)
9072	.375 (9.5)
9073	.500 (12.7)
9074	.625 (15.9)

Material: Nylon 6/6, UL Rated 94V-0

## PC SPACER SUPPORTS

- One end locks into chassis • Other end supports the PC Board
- Ideal for mid supports of large boards
- Simplifies assembly for multiple support applications • Reduces the amount of holes required in PC board



.187 (4.8)

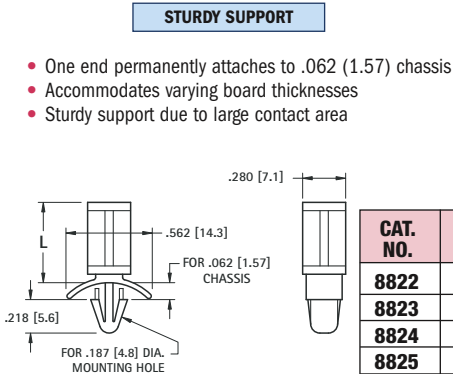

CAT. NO.	L LENGTH
8822	.187 (4.7)
8823	.250 (6.4)
8824	.375 (9.5)
8825	.500 (12.7)
8826	.625 (15.9)
8827	.750 (19.1)
8828	.875 (22.2)

Material: Nylon 6/6, UL Rated 94V-0



.100 (2.8)

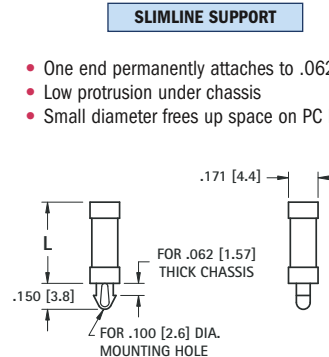

CAT. NO.	L LENGTH
9055	.125 (3.2)
9056	.187 (4.7)
9057	.250 (6.4)
9058	.375 (9.5)
9059	.500 (12.7)
9060	.625 (15.9)

Material: Nylon 6/6, UL Rated 94V-0

## REVERSE CHASSIS MOUNT SUPPORTS

- Permanently attaches to .059 (1.51) - .065 (1.65) thick case from outside
- Provides flat clean cosmetic appearance • Ideal for low clearance applications or for mounting directly to case walls



.156 (4.0)

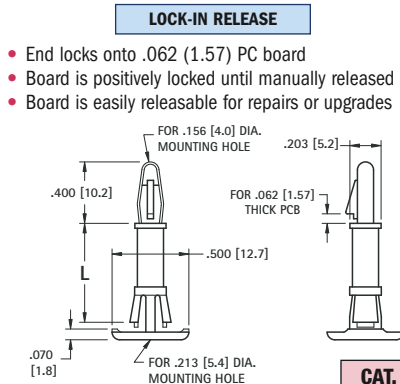

CAT. NO.	L LENGTH
9061	.250 (6.4)
9062	.375 (9.5)
9063	.500 (12.7)
9064	.625 (15.9)

Material: Nylon 6/6, UL Rated 94V-0



.125 (3.2)

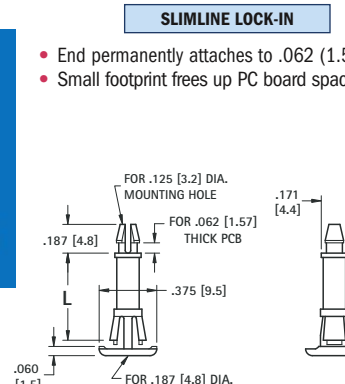

CAT. NO.	L LENGTH
9065	.250 (6.4)
9066	.375 (9.5)
9067	.500 (12.7)
9068	.625 (15.9)

Material: Nylon 6/6, UL Rated 94V-0

# SPACERS/STANDOFF ORGANIZER KITS



Maintain a neat complete inventory of the most frequently used spacers and standoffs in day-to-day operations. Choice of 14 different kits of the most popular spacers and standoffs. An assortment of various sizes and styles in Brass, Aluminum and Nylon with tapped or thru hole. Supplied with clear draw cabinet labeled for easy identification.

Kits combine the most frequently used spacers or standoffs for stacking and a multi-stacking prototyping.

SPACERS/STANDOFF KITS

## SPACER ASSORTMENT KITS



Assortment of 1500 pieces in .250, .375, .500, .750 and 1.000 lengths, with clearance holes for #4, #6 and #8.

100 pieces of each size. Complete with cabinet.

CAT. NO.	KIT SUPPLIED WITH
<b>SPR-13</b>	Brass Nickel Plated Spacers
<b>SPR-34</b>	Aluminum Spacers with Iridite Finish
<b>SPR-8</b>	Nylon 6/6 Spacers

## CLEAR HOLE SPACER KITS

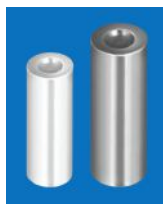

Assortment of 400 total spacers: Brass, Aluminum, Nylon, Rolled Aluminum, with lengths of .250, .500, .750 and 1.000.

25 pieces of each size. Complete with cabinet.

CAT. NO.	KIT SUPPLIED WITH
<b>SCR-4</b>	#4 Clear Hole Spacers
<b>SCR-6</b>	#6 Clear Hole Spacers
<b>SCR-8</b>	#8 Clear Hole Spacers

## HEX STANDOFF KITS



Assortment of 400 total standoffs: Female-Female standoffs and Male-Female standoffs both Aluminum and Nylon, with lengths of .250, .500, .750 and 1.000.

25 pieces of each size. Complete with cabinet and 25 machine screws with matching thread.

CAT. NO.	KIT SUPPLIED WITH
<b>STR-440</b>	4-40 Threaded Standoffs
<b>STR-632</b>	6-32 Threaded Standoffs
<b>STR-832</b>	8-32 Threaded Standoffs

## THREADED STANDOFF KITS



Assortment of 425 total pieces. Female-Female standoffs and Male-Female standoffs both aluminum and nylon, with lengths of 10mm, 12mm, 15mm and 20mm.

25 pieces of each size. Complete with cabinet and 25 machine screws with matching threads.

CAT. NO.	KIT SUPPLIED WITH
<b>STR-M3</b>	M3 Threaded Standoffs
<b>STR-M4</b>	M4 Threaded Standoffs

## FEMALE-FEMALE STANDOFF KITS



Assortment of 1500 pieces in .250, .375, .500, .750 and 1.000 lengths, with thread sizes of 4-40, 6-32, and 8-32.

100 pieces of each size. Complete with cabinet.

CAT. NO.	KIT SUPPLIED WITH
<b>STR-15</b>	Round Brass Zinc Plated Standoffs
<b>STR-35</b>	Round Aluminum Standoffs with Iridite Finish
<b>STH-14</b>	Hex Brass Zinc Plated Standoffs
<b>STH-22</b>	Hex Aluminum Standoff with Iridite Finish

## MALE-FEMALE STANDOFF KITS



Brass kit is an assortment of 750 pieces of .500, .750, 1.000, and 1.500 long standoffs with 4-40, 6-32 and 8-32 thread.

Complete with cabinet.

Stainless kit is an assortment of 250 pieces of .250, .500, .750, and 1.000 long standoffs with 4-40, 6-32 and 8-32 thread.

Complete with cabinet and 25 pieces of each screw size.

CAT. NO.	KIT SUPPLIED WITH
<b>STH-18</b>	Aluminum-Clear Iridite Standoffs
<b>STH-19</b>	Brass-Nickel Plate Standoffs
<b>STH-20</b>	Stainless Steel Standoffs

## SELF-RETAINING SPACER ENGINEERING DESIGN KIT



Assortment of 400 total pieces per kit of Self Retaining Round Nylon Spacers. Lengths of .125, .250, .500 and .750

25 pieces of each size/style.  
Complete with cabinet.

CAT. NO.	KIT SUPPLIED WITH
<b>SCR-10</b>	#4, #6, #8 & #10 Spacers

## CIRCUIT BOARD SPACER/SUPPORT ENGINEERING DESIGN KITS



Assortment of 400 total pieces per kit of a variety of Circuit Board Hardware in .125, .250, .375 and .500 lengths in Nylon 6/6 material.

25 pieces of each size/style.  
Complete with cabinet.

CAT. NO.	KIT SUPPLIED WITH
<b>CBH-1</b>	SlimLine Products - Tension Fit; Lock-In, Easy Lock and Single Sided
<b>CBH-2</b>	Lock-In Products - Tension Fit; Lock-In, Easy Lock and Single Sided
<b>CBH-3</b>	Stacking Products - Thru-Hole and Self Aligning



### Spacers & Standoffs

Certified Quality & Proven Performance  
ISO 9001:2015 Quality System



[www.keyelco.com](http://www.keyelco.com)

Access 3D Data Sheets  
& Check Availability



THiNK Design Solutions with Keystone Spacers & Standoffs